

Oaks on the River Campground Location

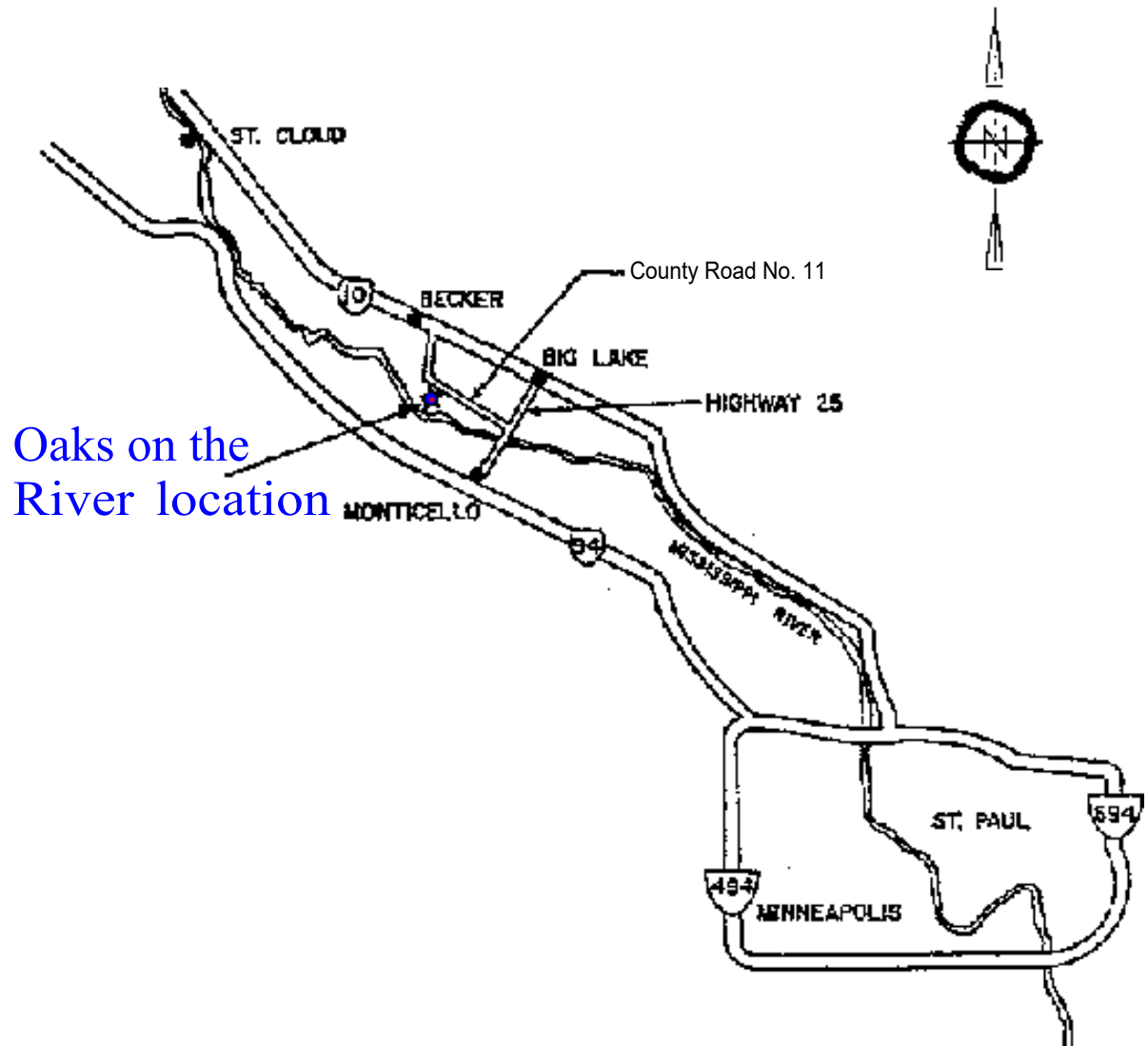

Oaks on the River Campsites

NOTE: All sites have at least 2 30 Amp Outlets and 1 20 Amp Outlet

Site #	Water/Elec	Units	Description
1	W/30 Amp	2	
2	W/30 Amp	3	Large Private Site
3	W/30 Amp	3	
4	W/30 Amp	3	
5	W/30 Amp	2	By the Pool & Bath House
6	W/30 Amp	2	Water & Electric
7	W/30 Amp	2	Pull Through
8	W/30 Amp	2	
9	W/30 Amp	2	
10	W/30 Amp	2	
11	W/30 Amp	4	Large Pull Through
12	W/30 Amp	2	
13	W/30 Amp	4	Large Site
14	W/30 Amp	2	
15	W/30 Amp	2	Cul-De-Sac
16	W/30 Amp	2	Cul-De-Sac
17	W/30 Amp	2	Cul-De-Sac - Center
18	W/30 Amp	2	Cul-De-Sac
19	W/30 Amp	2	Cul-De-Sac
20	W/30 Amp	2	Cul-De-Sac
21	W/30 Amp	2	
22	W/30 Amp	2	
23	W/30 Amp	2	
24	W/30 Amp	2	

Site #	Water/Elec	Units	Description
25	W/30 Amp	2	
26	W/30 Amp	2	
27	W/30 Amp	2	
28	2W/30 Amp	4	Pull Through just off the river
29	W/30 Amp	2	
30	W/30 Amp	2	
31	W/30 Amp	2	Site on the river
32	W/30 Amp	2	Across from river
33	W/30 Amp	2	Across from river
34	W/50/30/20 Amp	3	Across from river
35	W/30 Amp	2	Across from river
36	W/30 Amp	2	
37	W/30 Amp	2	
38	W/30 Amp	2	
39	W/30 Amp	3	
40	W/30 Amp	3	
41	W/30 Amp	2	
42	W/30 Amp	2	

Oaks on the River Campground Site Map

1 Unit = 8' by 20'

All sites have 30 Amp electrical service.

